

RMQ Titan
Dimensions

Pushbutton operators and indicating lights

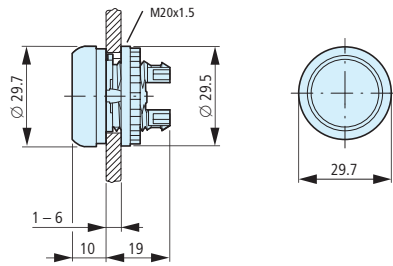

Pushbutton operators
M22-D

M22-DH

M22-DG(L)

M22-DD

M22-D, base mounting

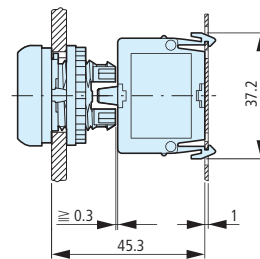
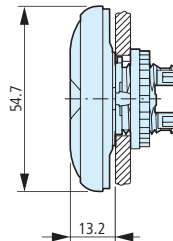
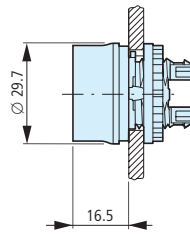
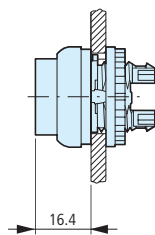
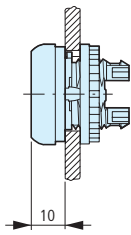

Selector switches

M22-W(R)...

M22-W(R)K...
M22-W(R)LK...

Key-released selector switches
Individual lock mechanisms
M22(S)-W(R)S-(MS...)

Master key systems
M22(S)-W(R)S-SA...

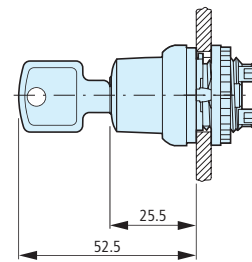
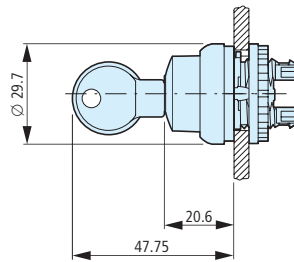
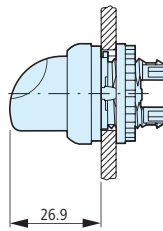
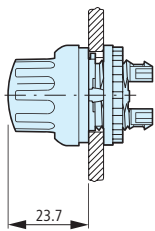

Indicating lights

M22-LH

M22-L

Illuminated pushbutton operators
M22-DL

M22-DLH

Mushroom-head operators
M22-DP

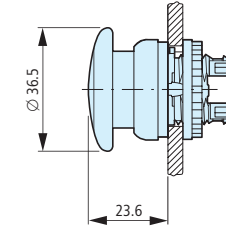
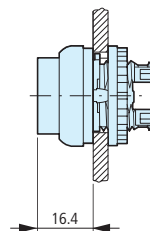
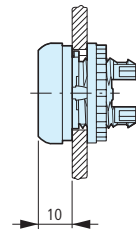
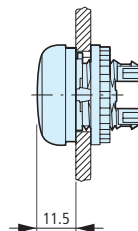
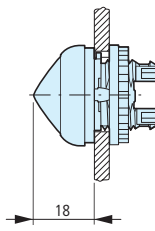

Compact indicating lights
M22-LC-..., M22-AM

M22-LCH-...

Emergency-Stop operator
M22-PV, M22S-PV
M22-PVL, M22-PVS-...

Potentiometer
M22(S)-R...K

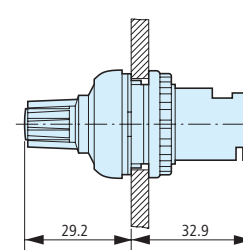
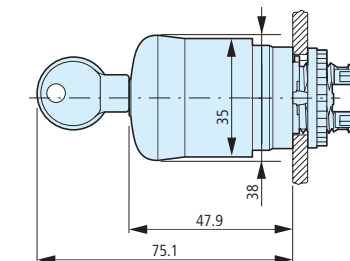
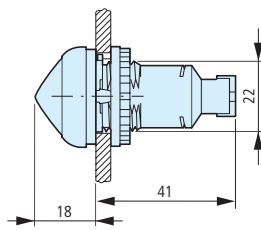
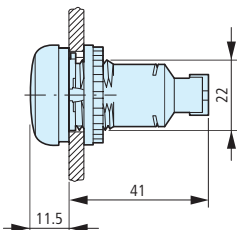

RMQ Titan
Dimensions

Front mounting (style: flush mounting)

Mounting adapter
M22-A

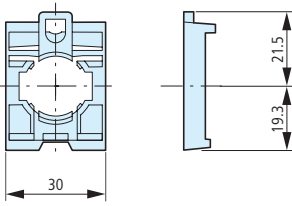

Centering adapter
M22-ZA

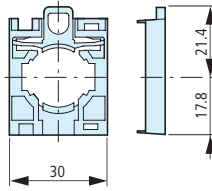

Indicating lights/illuminated pushbuttons

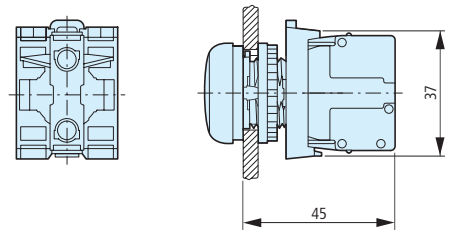

Pushbutton with M22-(C)K...
Pushbutton with M22-(C)LED...+M222-XLED

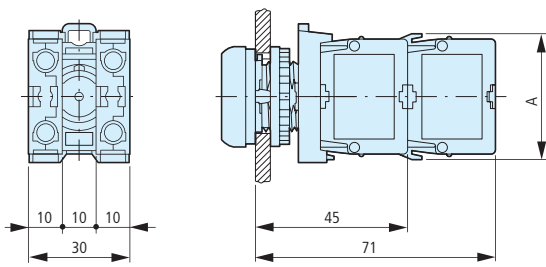

Surface mounting adapter

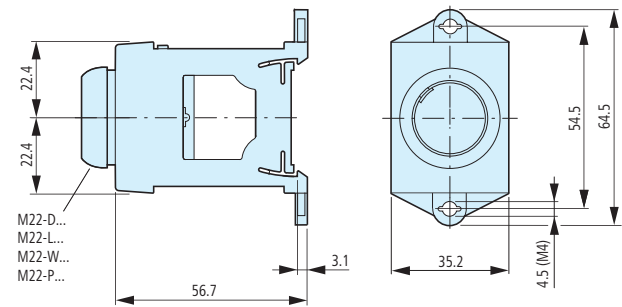

	1 × M22-K...	2 × M22-K...	1 × M22-CK...	2 × M22-CK...
A	37.2	37.2	39	39

Pushbutton, illuminated pushbutton, indicating light
With telescopic clip

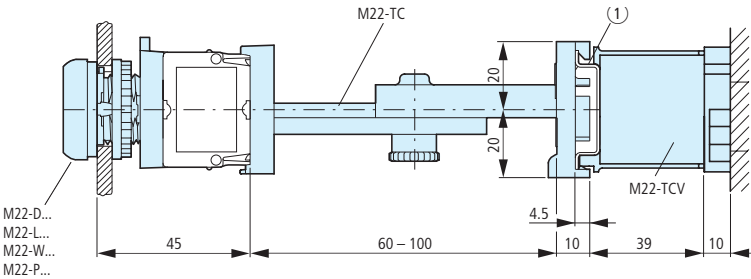

Foot and palm switches
FAK...

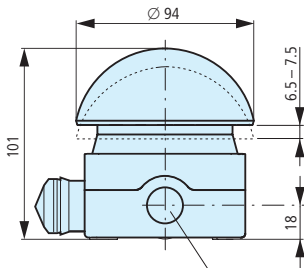

① 3 x M20, laterally
1 x M16 in the bottom

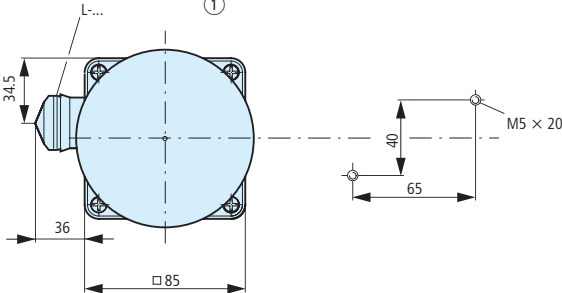

RMQ Titan
Dimensions

Front mounting (style: flush mounting)
Flush mounting panels M22-E...

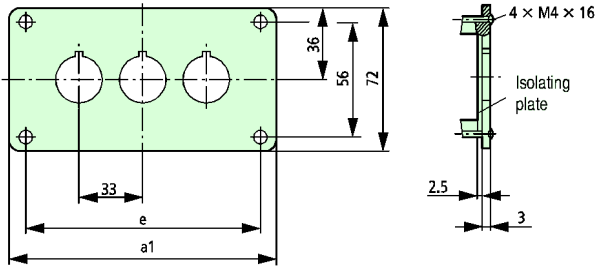

Type	a1	e
E (Y) 1	72	56
E 2	105	89
E 3	138	122
E 4	171	155
E 5	204	188
E 6	237	221

Base mounting (style: surface mounting)
Surface mounting enclosures M22-I...-PG

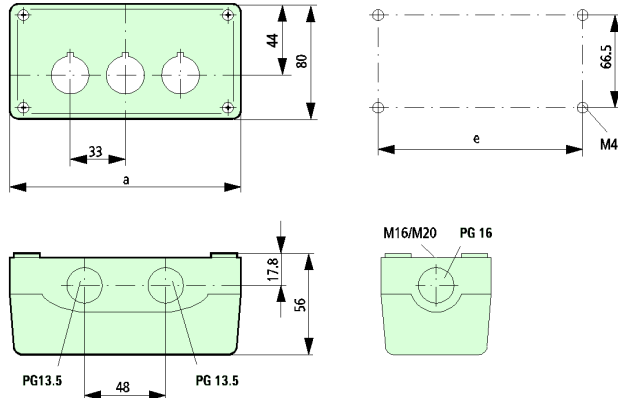

Shrouds M22-H...

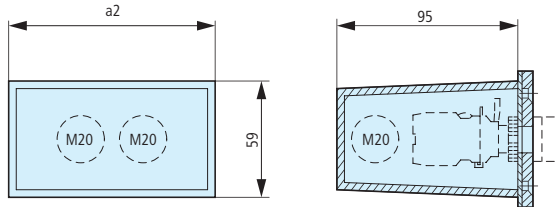

Type	Number of locations	a	e	Cable entries		
M22-I (Y) 1	1	72	58.5	2 × M16	1 × PG13.5	2 × PG16
M22-I2	2	120	106.5	2 × M16	1 × PG13.5	2 × PG16
M22-I3	3	153	139.5	2 × M16	2 × PG13.5	2 × PG16
M22-I4	4	186	172.5	2 × M16	2 × PG13.5	2 × PG16
M22-I6	6	252	238.5	2 × M16	2 × PG13.5	2 × PG16

Type	a2	Cable entry	Style
H 1	42	3 × M20	One-part
H 2	75	4 × M20	
H 3	108	4 × M20	
H 4	141	4 × M20	Multi-part
H 5	174	5 × M20	
H 6	207	6 × M20	

Shroud with plaster keys M22-UPE

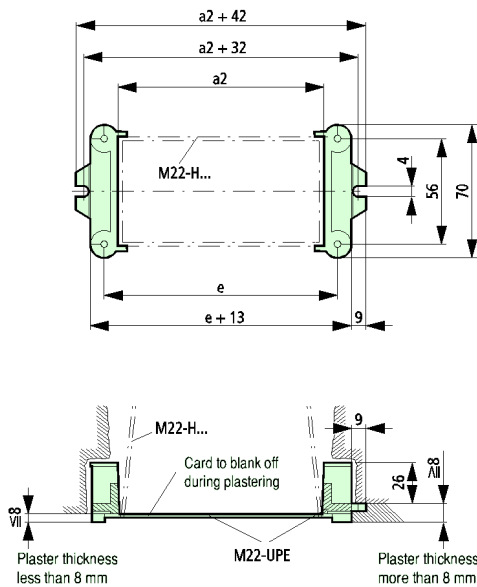

**RMQ Titan
Dimensions**

Legend plates
M22-ST

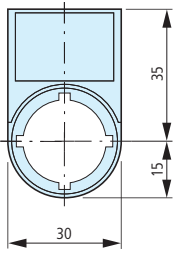

M22-STDD

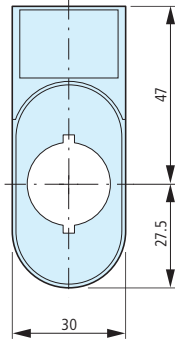

Mounting holes with/without lug slot

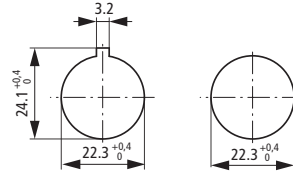

Grid dimensions to IEC/EN 60 947

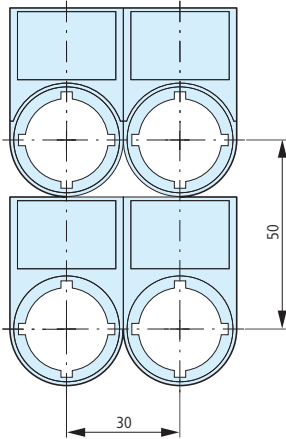

Minimum grid dimensions

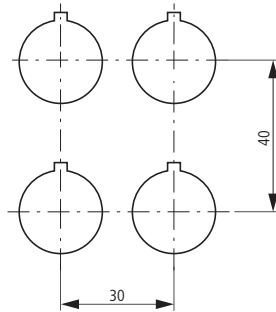

Grid dimensions for various combinations

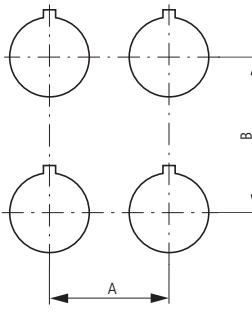

Type	A ≧ mm	B ≧ mm
M22(S)-...(IEC/EN 60 947)	30	50
RMQ-Titan min.	30	40
M22-D... + M22-T-D	33	40
M22-D(R)P...	38	40
M22-PV...	38	40
M22-PV(L) + M22-PL-PV	48	56
M22-PV(L)(S...) + M22-D...	33	40
M22-DDL...	30	55
M22-DDL... + M22-T-DD	33	58
M22-ST...	30	50
M22-STDD...	30	75
M22-CK...	30	45
M22-CLED...	30	45
M22-XAK...	90	90
M22-XZK...	33	52
M22-XBK...	60	60
M22-XYK...	50	50

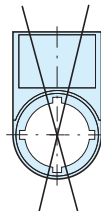

Do not use operator diaphragms with legend plates, since the legend plates do not comply with IP67.

Grid dimensions for M22-DD...

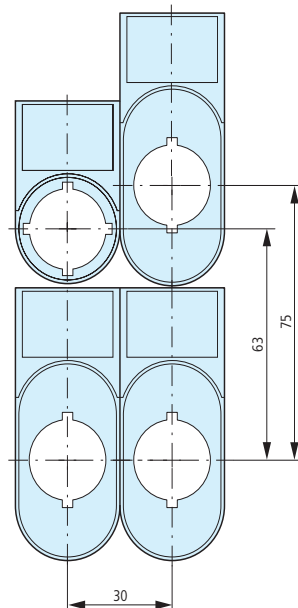

Grid dimensions for DDL double pushbuttons plus MT-DD diaphragms

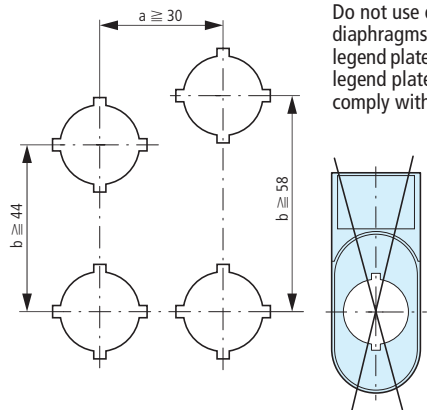

Do not use operator diaphragms with legend plates, since the legend plates do not comply with IP67.

RMQ Titan Dimensions

Accessories

M22-PL-PV

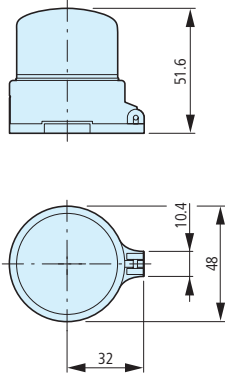

M22-B

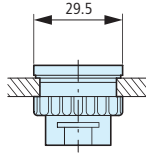

M22-T-D

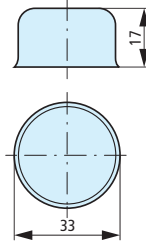

M22-T-DD

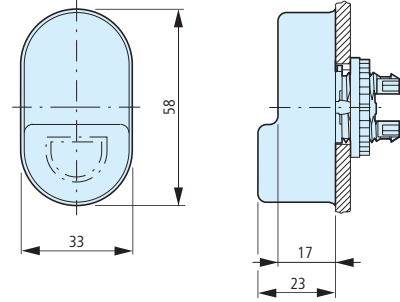

Emergency-Stop label

M22-XAK

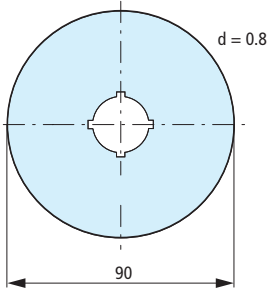

M22-XZK...

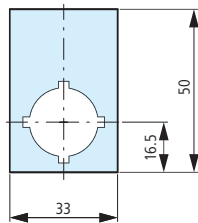

M22-XBK1

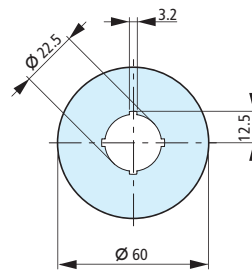

M22-XYK1

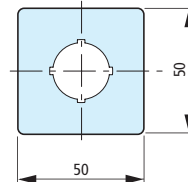

Protective collar

M22-XGWK

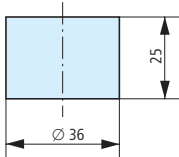

M22-XGPV

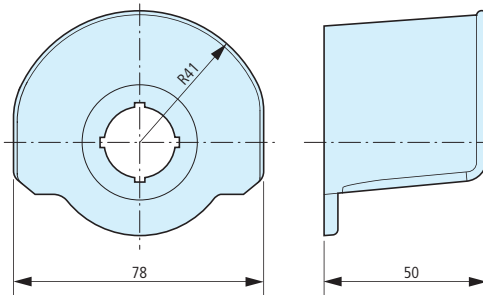

Protective cover

M22-XWS

