

RMQ16
Dimensions

Pushbutton operators and indicating lights

Pushbuttons and Stacklights

Square style

Q...BS

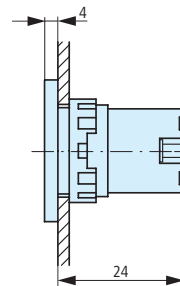
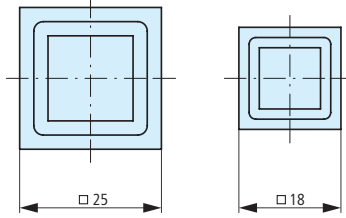
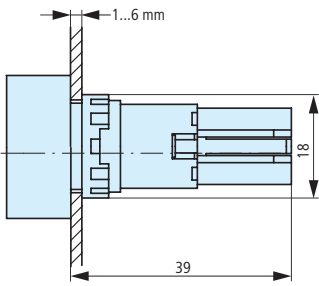

Q...D-...
Q...DR-...

Q...S...

Q...WK...

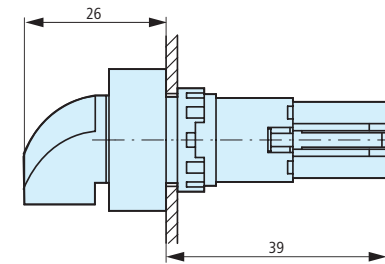
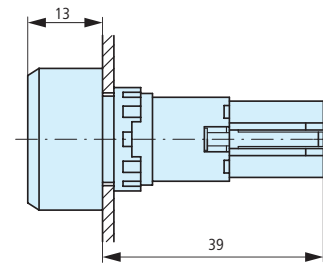
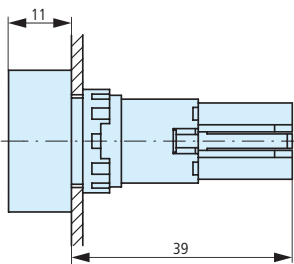

Q...LT-...
Q...LTR-...
Q...LF-...

Q...LH-...

Q...LWK-...

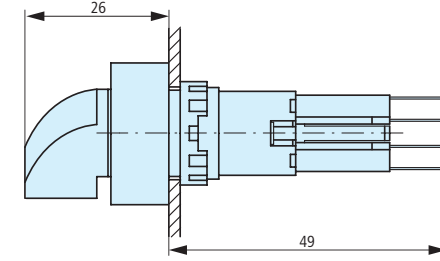
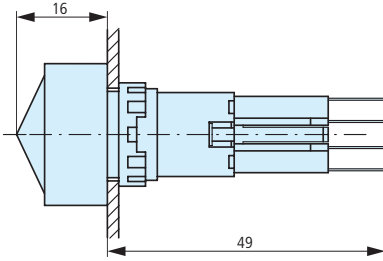
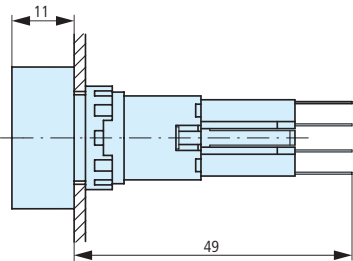

Q25PV
Q25LPV

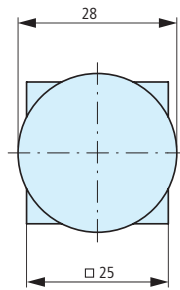
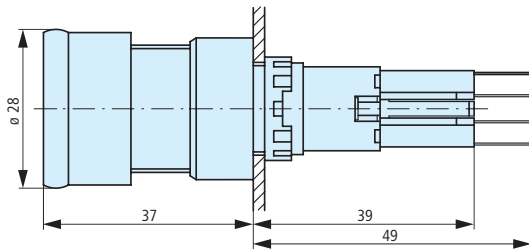

RMQ16
Dimensions

Front mounting

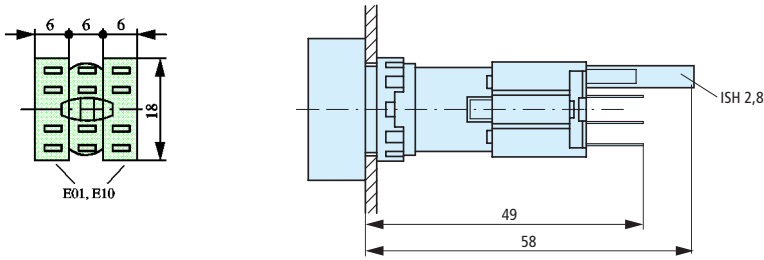

Drilling dimension

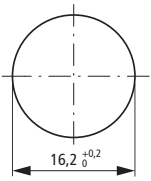

Grid dimensions to IEC/EN 60 947 Q25...

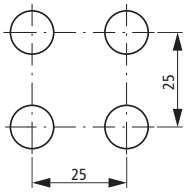

Minimum grid dimensions Q18...

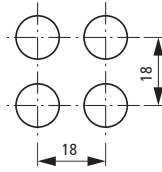

Mounting distances

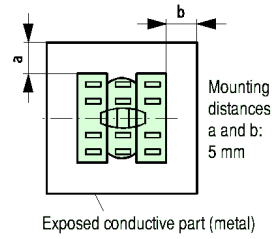

Flush mounting panels

E8/E8-SW

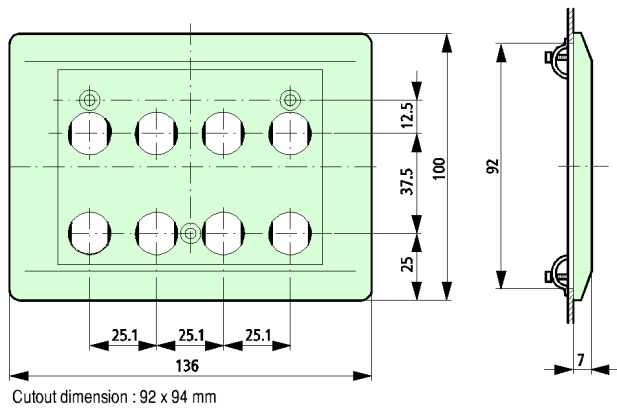

Screw adapter

SRA...

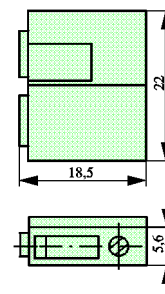

Anti-rotation feature

VS

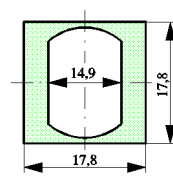

RMQ16
Dimensions

Surface mounting enclosures

I8

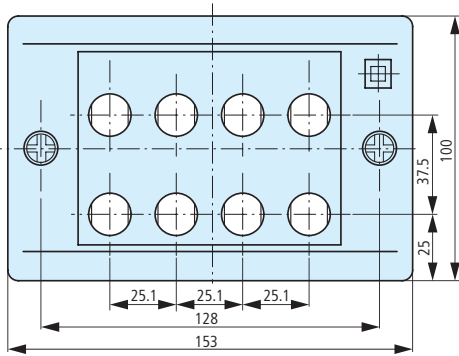
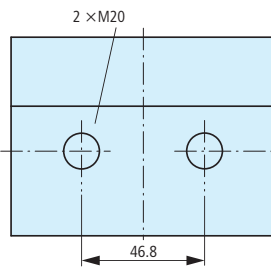
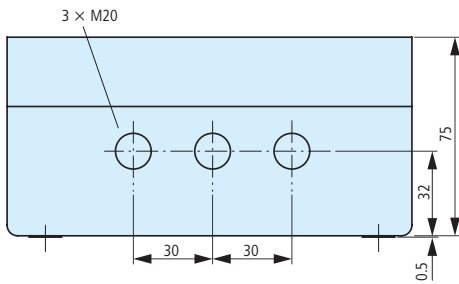
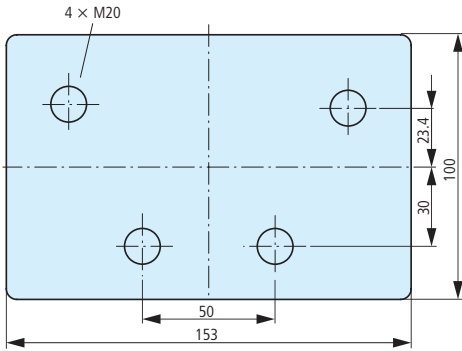

Mounting holes: 2 x 4.5 mm diameter
Spacing dimensions: 128 mm

PCB adapter

PRA16

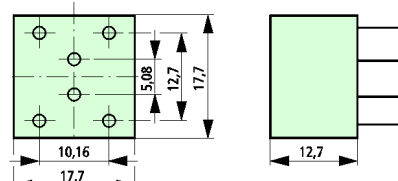

Cross section of solder: 0.6 x 0.6 mm

Legend plate

Q25TS...

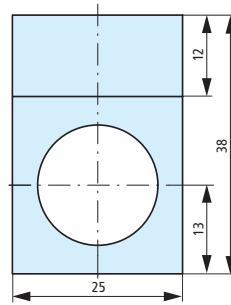

Blanking plate

Q25AS

